

REPLACEMENT PARTS SUITABLE FOR ESAB®/L-TEC®

PT-27™

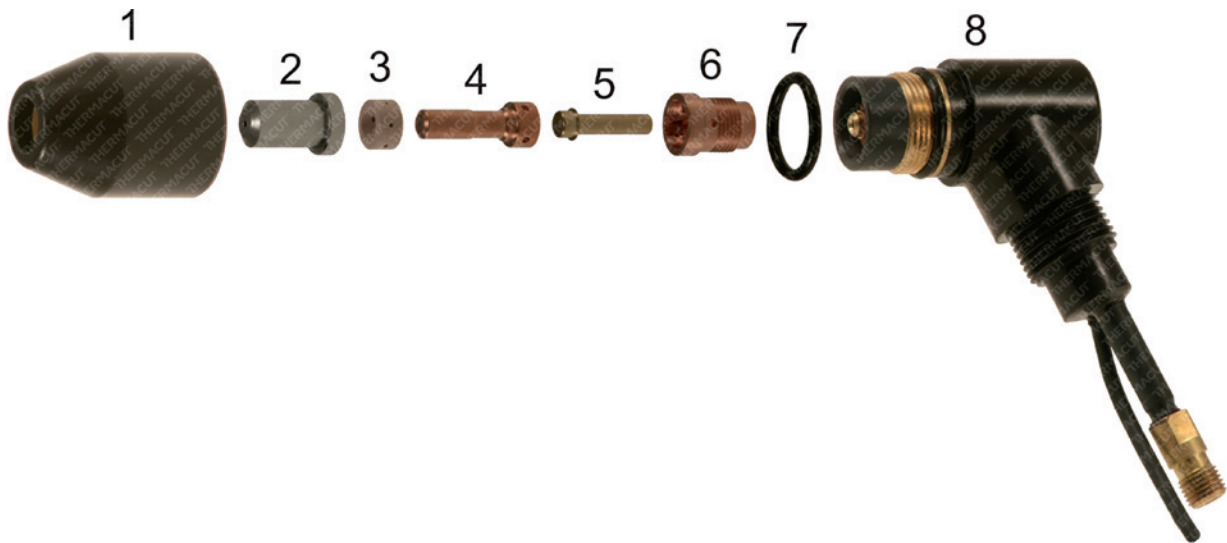

Item	Part No.	Ref. No.	Description	Std. Pkg.	Item	Part No.	Ref. No.	Description	Std. Pkg.
1.	T-1307	21616	Heat Shield	1	6.	T-1310	21615	Replaceable Seat	5
2.	T-1260	33368	Nozzle 0,9mm 30A	10	7.	T-1306	85W51	O-Ring	1
	T-1261	33369	Nozzle 1,2mm 50-70A	10	8.	T-1309	21610	Torch Body 70°	1
	T-1262	33418	Nozzle 1,3mm 80A	10	NS	T-1986	21420	Stand-off Guide	1
	T-0057	35442	Gouging Nozzle 2,4mm	10	NS	PT-10220	0558003032	Seat Assembly	1
3.	T-1263	33367	Swirl Baffle	5	NS	T-3953	0558003027	Seat Installation Tool	1
4.	T-1264	33366	Electrode	10	NS	KT-1301	21620	PT-27™ Cable Leads, 7,6m (25')	1
5.	T-1308	21619	Valve Pin	5					

PT-31XL™



Item	Part No.	Ref. No.	Description	Std. Pkg.	Item	Part No.	Ref. No.	Description	Std. Pkg.
1.	T-1174	20860	Nozzle XT 30-40A	10		T-1175	21008	Nozzle 35-40A	10
	T-1176	20861	Nozzle XT 50A	10	2.	T-1173	20862	Electrode XT	10

Last update of this page: 11/11/2018. See Revision history for details.

THERMACUT®
THE CUTTING COMPANY™

WWW.THERMACUT.CZ
TEL.: +420.556 423 418
SALES@THERMACUT.CZ

WWW.THERMACUT.DE
TEL.: +49 (0) 27 39 40 33 0
INFO@THERMACUT.DE

WWW.THERMACUT.COM
TEL.: 1-603-542-6715
CUSTOMERSERVICE@THERMACUT.COM

THERMACUT®, THE CUTTING COMPANY®, FHT-EX®, EX-TRAFIRE®, EX-TRACK® AND EX-TRABEAM® ARE REGISTERED TRADEMARKS OF THERMACUT, K.S. AND MAY BE REGISTERED IN CZECH REPUBLIC AND/OR OTHER COUNTRIES. ALL OTHER TRADEMARKS ARE PROPERTIES OF THEIR RESPECTIVE OWNERS. THERMACUT IS NO WAY AFFILIATED WITH ESAB®/L-TEC®. MOST THERMACUT PARTS ARE MADE FOR OR BY AN IBG COMPANY. PARTS INDICATED WITH A OEM ARE ORIGINAL PARTS MANUFACTURED BY THE ABOVE NAMED MANUFACTURER AND ARE BEING RESOLD BY THERMACUT. THERMACUT RESERVES THE RIGHT TO SUBSTITUTE OEM PARTS IN PLACE OF THERMACUT PARTS.
VALID FROM NOVEMBER 2018 • PREVIOUS VERSION IS NO LONGER VALID. • © COPYRIGHT 2018 BY THERMACUT® CZECH REPUBLIC. ALL RIGHTS RESERVED.